



## VKCD-1311SM/VF

Article-No.: 92049

1/3" Dome, Fixed, Colour,  
tinted, 4-9mm, 550TVL, 12VDC

### Main features

For wall and ceiling surface mounting  
Tinted Lexan bubble, 100mm  
Integrated F1.5/4-9mm varifocal lens w. DC iris  
Digital signal processing (DSP)  
Automatic white balance (ATW)

Vandal and tamper-resistant  
1/3" colour board camera with Super HAD CCD  
Resolution of 550 horizontal lines  
Backlight compensation (BLC)  
Manual 3-axis camera adjustment

### Specifications

System	colour
Video standard	PAL
Sensor size	1/3"
Imager	CCD
Imager	Sony Super HAD Interline Transfer
Active picture elements	440,000, 752(H) x 582(V)
Horizontal resolution	550 TVL
Synchronization	internal
Signal-to-noise ratio	48dB
Gamma correction	approx. 0.45
Sensitivity (at 50% video signal)	0,3 Lux
Sensitivity (at 50% video signal)	at F1.2 (measured)
Automatic gain control (AGC)	On/Off switchable
Low speed shutter	no
Digital Noise Reduction (DNR)	no
Backlight compensation	BLC
Backlight compensation	ON/OFF switchable

## Specifications (continued)

Wide Dynamic Range (WDR)	no
Aperture Correction (APC)	horizontal and vertical
Flickerless function	On/Off switchable
IR cut filter	standard
Activity detection	no
Digital zoom	no
Lens type	varifocal
Focal length	4 mm - 9 mm
Horizontal angle of view	71° - 31,6°
Video outputs	composite (CVBS)
Video outputs	1Vp-p, CVBS, 75ohms
Alarm inputs	-
Alarm outputs	-
e-PTZ support	no
Rotation range	359°
Illumination	no
Serial interfaces	no
Housing	outdoor
Housing	Die-cast aluminium with tinted polycarbonate bubble
Housing material	aluminium
Bubble	100mm diameter, Vandal resistant 3mm -tinted- polycarbonate with high resistance
Colour (bubble)	tinted
Colour (housing)	Pantone Cool Gray 1C
Heater	no
Mounting	ceiling mount, wall mount
Supply voltage	12VDC
Supply voltage	(9 ~ 15VDC), 12VDC ±0,5V recommended
Power consumption	3.0W max.
Temperature range (operation)	-10°C ~ +50°C
Protection rating	IP65
Vandalism resistant	yes
Dimensions (HxWxD)	see drawing
Weight	840g
Certificates	DGUV test certificate, CE

## Optional Accessories

Image	Artikel-Nr. / Typ	Description
	VT-PS12DCDT1	PSU 12VDC/1.0A, Regulated, Desktop Version, 1.8m Cables each w. open ends
	1/2" - M25X1.5	Thread Adapter 1/2" - Conduit Connection M25x1.5mm for VKCD-131x Housings
	VT-PS12DC-7	Plugable PSU w. Cont. & UK Mains plug-in 100-240VAC/12VDC-1.25A, Regulated
	VT-PS12DC-8	Plug-in Power Supply Unit 100-240VAC 12VDC (1.0Amp), Regulated, with DC Plug
	VDOME/WB2	Wall Mount Kit for Vandalism Resistant Dome Cameras SMVF Series

## Technical Drawing

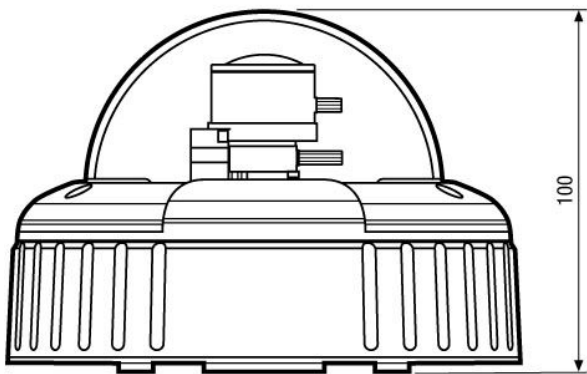
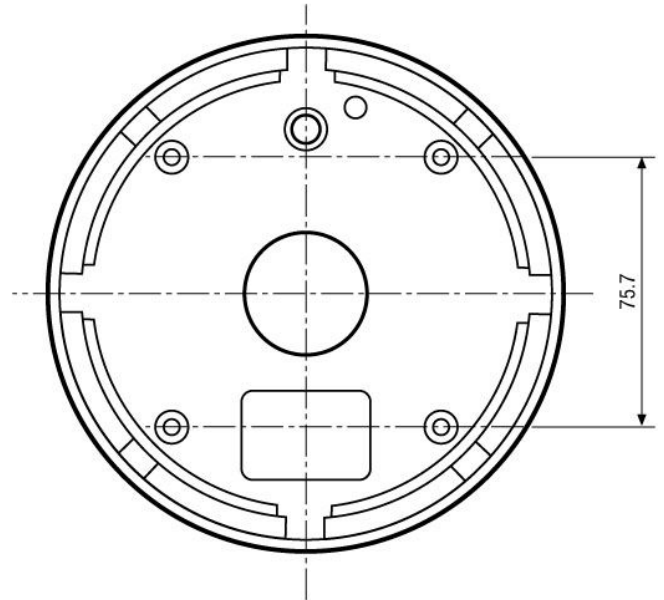
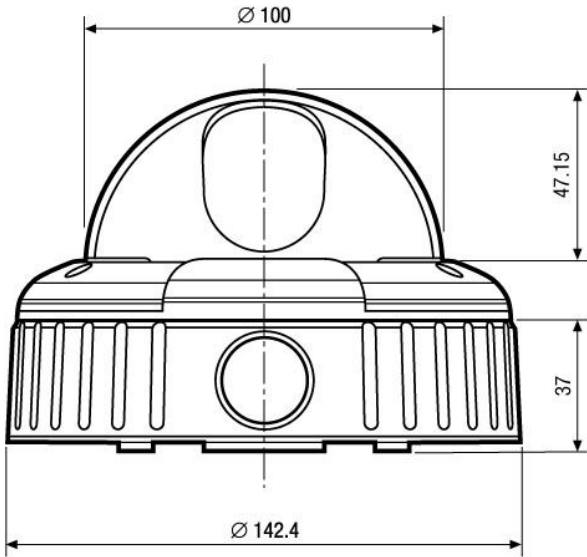

Maße/Dimensions: mm

Your partner for eneo products:

