



VKC-1366

Article-No.: 92529

1/3" Board Camera, Colour,
3.6mm, 550TVL, Housing, 12VDC

Mainfeatures

CCD colour board camera in metal housing
Automatic shutter control (ESC)
Automatic white balance (AWB)
Interchangeable lens element

1/3" Sony Super HAD II CCD
Automatic gain control (AGC)
Sensitivity of 0.2Lux (F1.2)
Supply voltage: 12VDC



Specifications

System	colour
Sensor size	1/3"
Imager	CCD
Imager	Sony Super HAD Interline Transfer
Active picture elements	440,000 (H) 752 x (V) 582 pixels
Synchronization	internal
Gamma correction	0.45
Horizontal resolution	550 TVL
Sensitivity (at 50% video signal)	0,2 Lux
Sensitivity (at 50% video signal)	at F1.2 (measured)
Automatic electronic shutter (ESC)	1/50 - 1/100,000sec.
Low speed shutter	no
Automatic gain control (AGC)	yes
Digital Noise Reduction (DNR)	no
White balance	automatic
Backlight compensation	no
Wide Dynamic Range (WDR)	no
Aperture Correction (APC)	horizontal and vertical

Specifications (continued)

IR cut filter	standard
Video outputs	composite (CVBS)
Lens type	fixed focal length
Lens	F2.0/3.6mm w/o. iris
Focal length	3,6 mm
e-PTZ support	no
Digital zoom	no
Horizontal angle of view	69°
Iris control	no
MOD (Minimum object distance)	0,1 m
Illumination	no
Activity detection	no
Serial interfaces	no
External connections	Video (BNC), 12 VDC (DC socket)
Temperature range (operation)	-10°C ~ +50°C
Housing material	aluminium
Housing	indoor
Integrated wall mount	no
Hidden cable management	no
Sunshield	no
Window heater	no
Colour (housing)	black
Vandalism resistant	no
Protection rating	n/a
Alarm inputs	-
Alarm outputs	-
Supply voltage	12VDC
Power consumption	0.72W
Dimensions (HxWxD)	25x26x28.5mm
Weight	28g
Parts supplied	Camera with U bracket, Connection cable kit, Manual
Certificates	CE

Optional Accessories

Image	Artikel-Nr. / Typ	Description
	H0225M	F2.5/2.5mm Board Camera Lens, 1/3" M12X0.5
	H0820M	F2.0/8mm Board Camera Lens, 1/3" M12X0.5

Optional Accessories (continued)

Image	Artikel-Nr. / Typ	Description
	VT-PS12DC-8	Plug-in Power Supply Unit 100-240VAC 12VDC (1.0Amp), Regulated, with DC Plug

Technical Drawing

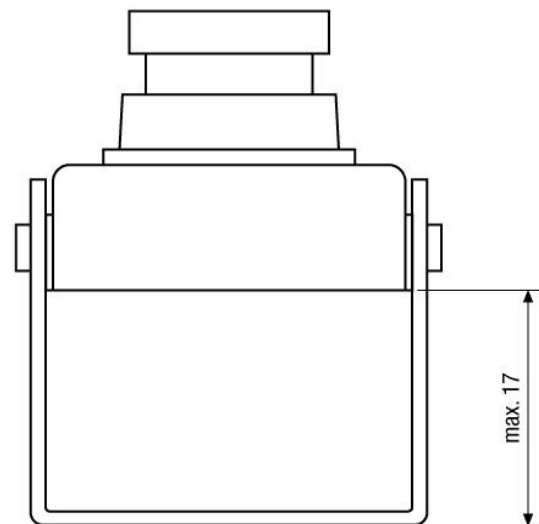
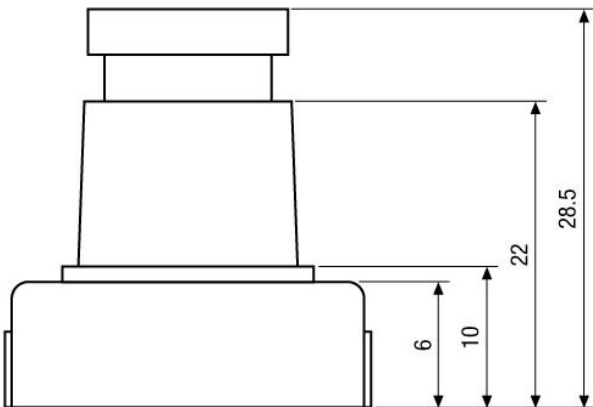
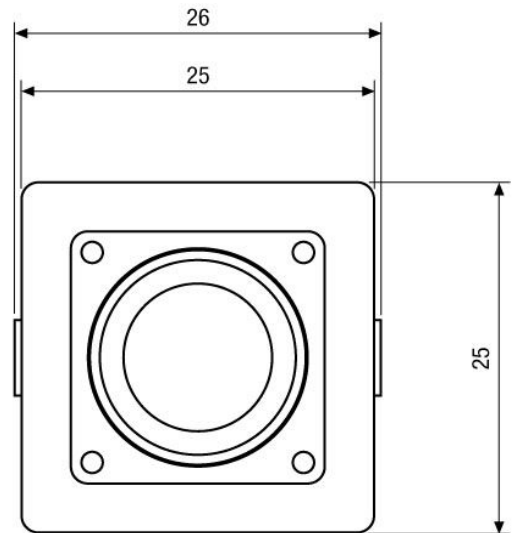
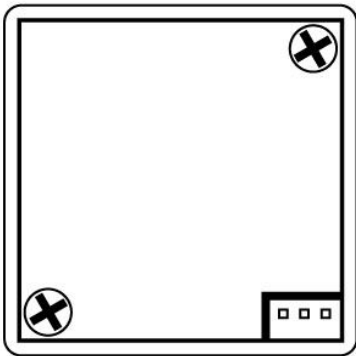

Maße/Dimensions: mm



Your partner for eneo products:

